

**For Lease:
Industrial Space**

**14 Jewel Dr
Wilmington, MA 01887**



**8,136 S.F.
OFFICE/
WAREHOUSE
AVAILABLE**

Building Specifications:

Total Area:	126,477
Year Built:	1984
Lot Size:	11.13 Acres
Clear Height:	22' Warehouse
Column Spacing:	28'-0" x 36'-10"
Loading Docks:	2 Tailboards

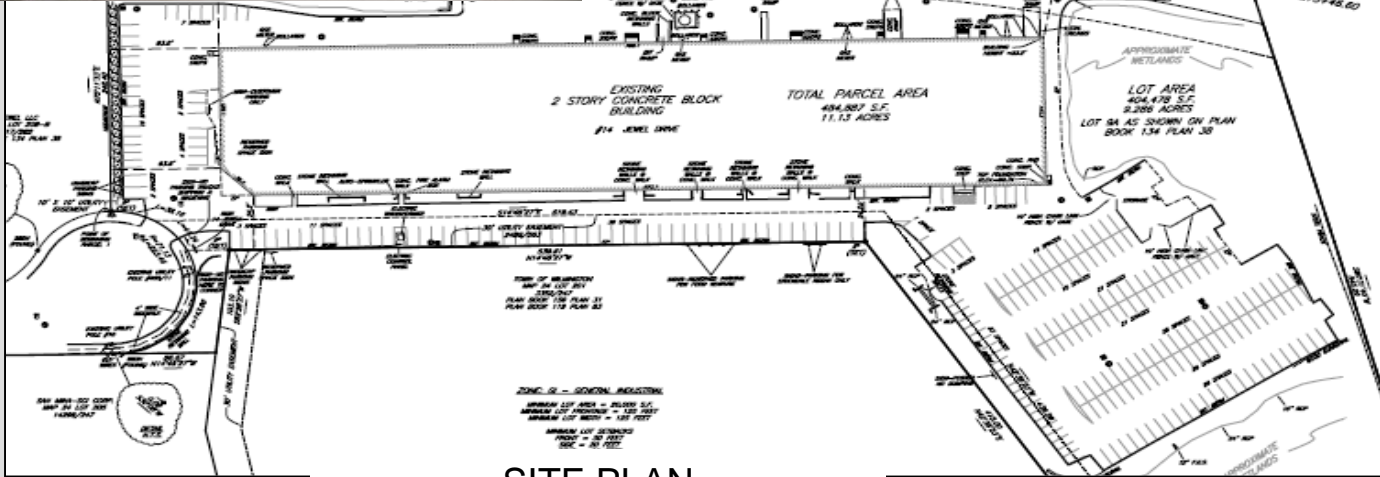
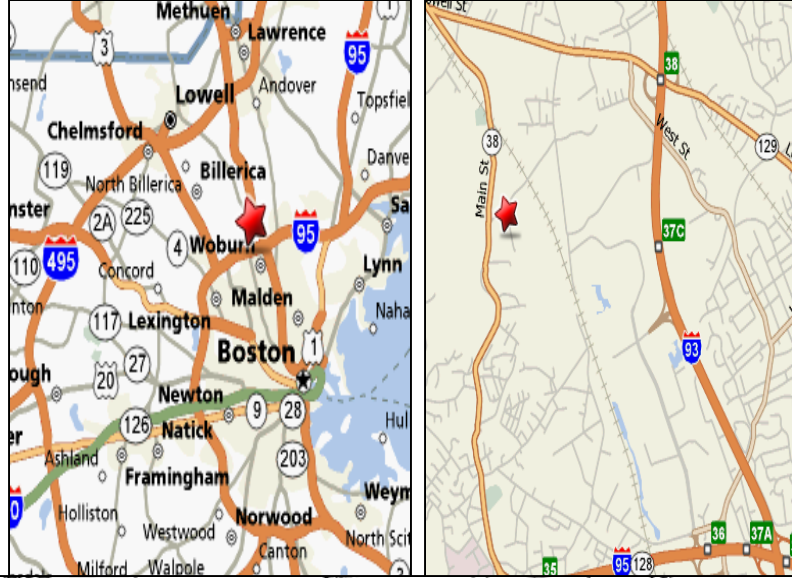

SITE PLAN

Howland Development Company
155 West Street
Wilmington, MA 01887
Tel: 978-657-6400
Fax: 978-658-8582

Contact: Jamie McManus
Tel: 978-657-6400, Ext. 14
Cell: 781-779-5365
jmcmamus@howlanddevelopment.com

Building Notes:

- Ample existing Office and Parking
- Landscaped and Well-Maintained
- 2.5 Miles to I-95/Rt. 128
- Less than 2 Miles From I-93
- 15 Miles from Downtown Boston
- Located on Cul-de-sac for Privacy